

**PLEASE BE AWARE OF THESE LATEST PLANNING UPDATES
THIS WILL EFFECT ALL RESIDENTS IN THE VILLAGE OF WHETSTONE**

The DWH Planning applications for Springwell Lane Phase 1 & 2 application numbers 10/0856/1/PX & 10/0857/1/OX, Springwell Lane Access Road application planning application number 11/0523/1/PY and Cambridge Road / Leveret Drive planning application number 11/0288/1/OX were **deferred** at the October BDC Development Control Committee following representations by the Parish and the Parish Council. Applicants were told to “go away and look at access issues and housing numbers” so as to fit in with the allocation of houses deemed necessary under Regional strategies. This currently implies that 181 houses need building by 2026.

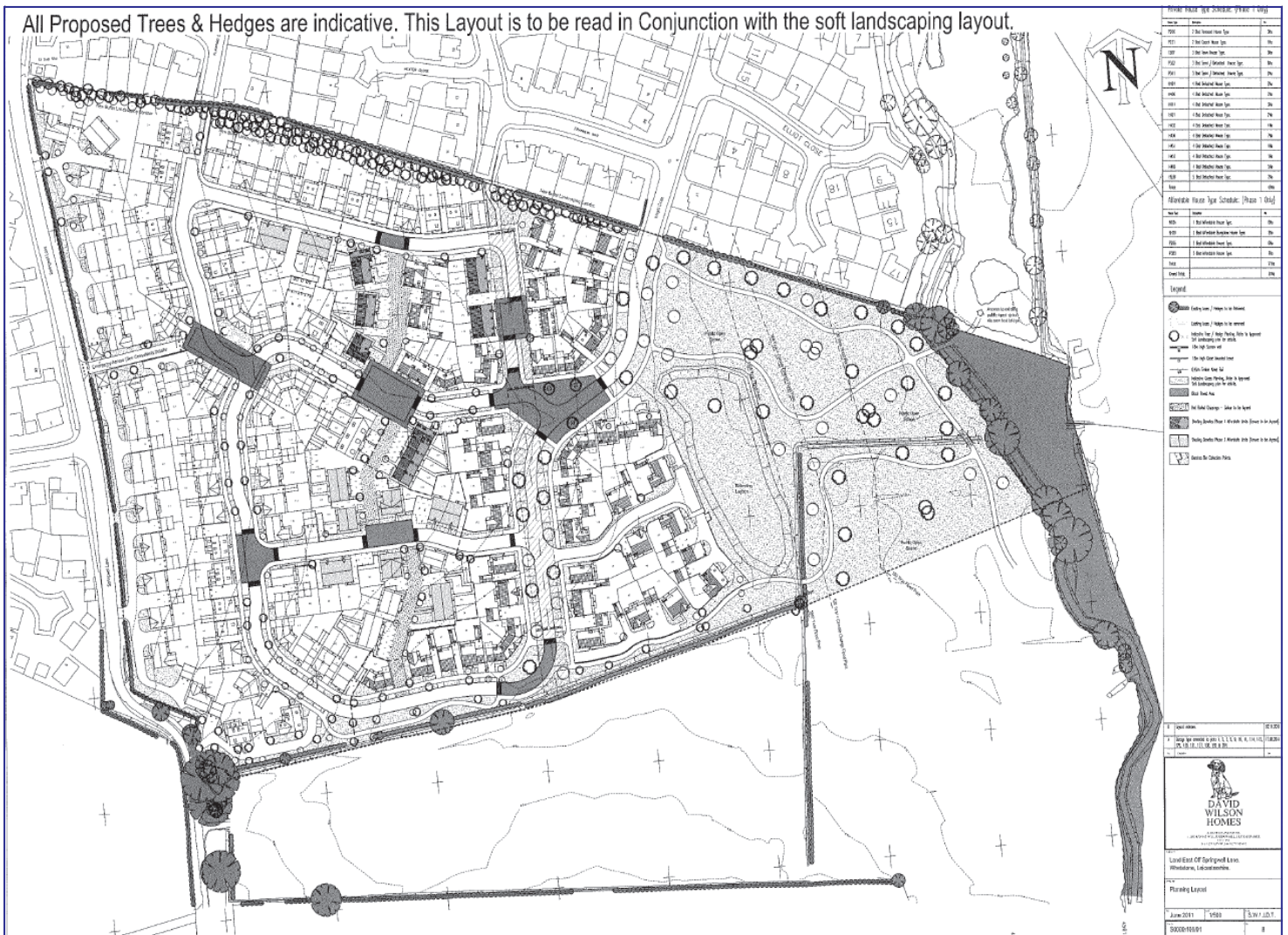

The Springwell Lane applications have now been revised (see above) and resubmitted to reflect a total of 177 houses over two phases. The lower field shown above was previously covered by housing and open space. DWH say that this alleviates the access issues by reducing the numbers. As this is classed by BDC as an amendment to the original application, we have ten working days to add comment on what they class as the amendments. We do not see the revisions as amendments and will be responding as such. We are also asking to speak at the Development Control meeting when the amended application’s is reconsidered. Our Chairman, Mark Jackson who registered to speak as a member of the public is also asking to speak as a parishioner again.

The official closing dates for comments is 25th November, but you can submit comments up until midday on the day of the Development Control meeting. We have now been informed by BDC that the DWH applications will be heard on Thursday January 5th 2012 at 4.30 P.M at the Council Chambers in Narborough.

Whetstone filled the room at BDC at the last Development Control meeting where over 150 people were in the public gallery. We would ask that if you are able to, please attend again and show that we are against this development on Springwell Lane. We also ask you to register your continued objection to these developments with BDC at the address below.

Any member of the public who wishes to speak can request to do so ahead of the agenda being published for the meeting which is 5 days prior to the meeting. Requests can be made directly to the Planning Department, Blaby District Council, Council Offices, Desford Road, Narborough, Leicester, LE19 2EP. They can be contacted by phone on 0116 272 7705 and by email on planning@blaby.gov.uk.

To request to speak on the Springwell Lane Phase 1 & 2 applications please quote the following planning application numbers: 10/0856/1/PX & 10/0857/1/OX. To request to speak on the Springwell Lane Access Road application please quote the following planning application number: 11/0523/1/PY.

The Dog & Gun Lane planning application number: 11/0370/1/OX for 34 houses on the old cricket ground at the pub was withdrawn by the applicant, Everards, and was sent for determination to the Secretary of State due to the non determination by BDC within an expected 12 weeks time frame. A duplicate application has now been submitted for determination on December 8th 2011 again at BDC. We have objected to the original application and also to the identical resubmitted application. Again we are asking to speak at the above meeting when it will be considered.

The Cambridge Road application with access off Leveret Drive has not been resubmitted to BDC at this point. Our understanding is that they will resubmit plans with an access off Cambridge Road. This may still be for 78 dwellings.

These applications are opposed by the Parish Council as we have Brownfield land in the village i.e. the old GEC site that would accommodate the housing numbers needed to satisfy current housing needed forecasts. In line with our representations, BDC have now changed their stance saying the land used for housing or mixed use would be acceptable. We will continue to push our policy of Brownfield site redevelopment ahead of any loss of countryside.

We will be publishing our responses on line as soon as they are completed and approved by Council.

**PLEASE GET INVOLVED AND SUBMIT YOUR OBSERVATIONS BEFORE IT IS TOO LATE –
YOUR VILLAGE NEEDS YOU**